



*jordan fishwick*

Western Lane Buxworth High Peak





**Western Lane Buxworth High Peak  
SK23 7NQ**

**£240,000**

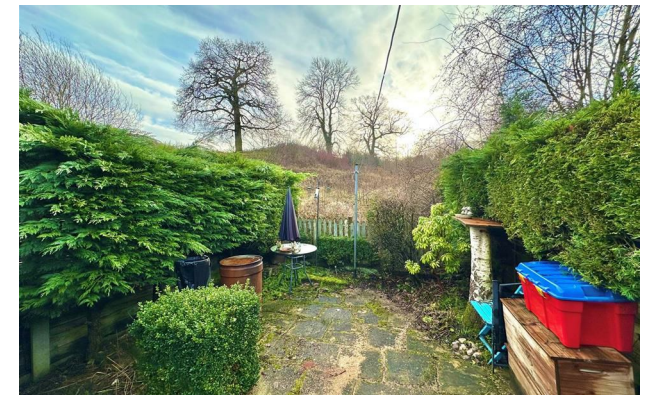

## The Property

Situated in the popular village of Buxworth and within easy reach of the beautiful Bugsworth Basin, a delightful, Stone-built mid terraced cottage. Backing onto farmland and well presented throughout this extended property has to be seen. Pvc double glazing, gas central heating and an open fire! Comprising: living room, dining kitchen, ground floor shower room with separate wc and two first floor bedrooms. A charming home in a sought after location!





- Backing onto open fields
- Popular, Sought After Location
- Stone Country Cottage
- Extended Ground Floor
- Private Garden
- Two Bedrooms
- Open Fire
- Close To Bugsworth Basin

Postcode

SK23 7NQ

EPC Rating

Local Authority

High Peak

Council Tax

B

Energy Efficiency Rating		
	Current	Potential
Very energy efficient - lower running costs		
(92 plus) <b>A</b>		
(81-91) <b>B</b>		
(69-80) <b>C</b>		
(55-68) <b>D</b>		
(39-54) <b>E</b>		
(21-38) <b>F</b>		
(1-20) <b>G</b>		
Not energy efficient - higher running costs		
<b>England &amp; Wales</b>	EU Directive 2002/91/EC 	



GROUND FLOOR

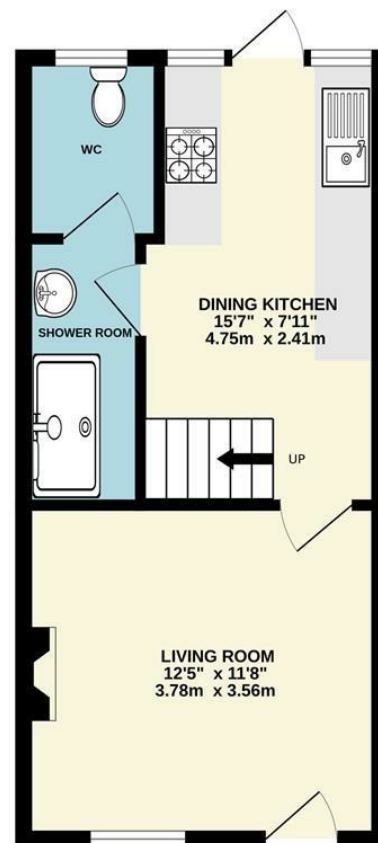

1ST FLOOR

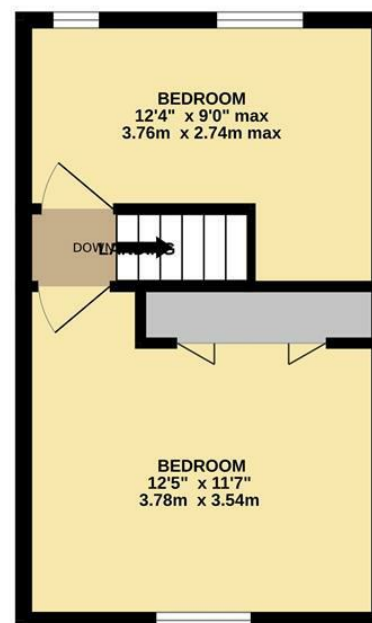

Whilst every attempt has been made to ensure the accuracy of the floorplan contained here, measurements of doors, windows, rooms and any other items are approximate and no responsibility is taken for any error, omission or mis-statement. This plan is for illustrative purposes only and should be used as such by any prospective purchaser. The services, systems and appliances shown have not been tested and no guarantee as to their operability or efficiency can be given.  
Made with Metropix ©2025



These particulars are believed to be accurate but they are not guaranteed and do not form a contract. Neither Jordan Fishwick nor the vendor or lessor accept any responsibility in respect of these particulars, which are not intended to be statements or representations of fact and any intending purchaser or lessee must satisfy himself by inspection or otherwise as to the correctness of each of the statements contained in these particulars. Any floorplans on this brochure are for illustrative purposes only and are not necessarily to scale.

Offices at: Chorlton, Didsbury, Disley, Hale, Glossop, Macclesfield, Manchester Deansgate, Manchester Whitworth Street, New Mills, Sale, Wilmslow and Withington

14 Market St, Disley, Cheshire, Stockport SK12 2AA

01663 767878

disley@jordanfishwick.co.uk

www.jordanfishwick.co.uk